

NOTE: CLEAR  
DOOR OPENING  
TO BE 18"

PLAN VIEW

**DURALUMINUM MODEL 4848SL BUILDING NOTES:**

- ①— 100 AMP, SINGLE PHASE 12 SPACE LOAD CENTER w/ MAIN BREAKER
  - ②— 115V DUPLEX OUTLET
  - ③— 115V DEDICATED DUPLEX OUTLET
  - ④— 34 WATT SURFACE MOUNTED FLUORESCENT T-8 LIGHT w/ SWITCH
  - ⑤— 115V, 13,500 BTU C - 5,400 BTU H ROOF MOUNT A/C
  - ⑥— 115V, 1500 WATT WALL MOUNTED HEATER (WIRED DIRECT)
  - ⑦— DUAL EXTERIOR SPOT LIGHT w/ SWITCH
  - ⑧— 14" DEEP STEEL PAINTED SHELF
- \* EXTERIOR ROOF w/ 3" OVERHANG (SHIPS INSTALLED)
  - \* 2066 HEAVY DUTY ALUMINUM SLIDING DOOR w/ HALF GLASS & HOOK BOLT DEAD LOCK
  - \* GLAZING: 3/16" CLEAR POLYCARBONATE
  - \* ALUMINUM TREAD PLATE FLOOR
  - \* STANDARD CONDUIT ACCESS CUTOUT
  - \* U.L. LABEL FOR COMPLIANCE WITH THE N.E.C.

THESE DRAWINGS AND SPECIFICATIONS HAVE BEEN PREPARED IN ACCORDANCE WITH PORTA-KING'S PRACTICAL AND THE PROJECT DESIGN. THE PROJECT WILL BE MANUFACTURED IN ACCORDANCE TO THIS INFORMATION AS SUBMITTED. THE SECURING OF BUILDING PERMITS AND COMPLIANCE WITH APPROPRIATE BUILDING CODES IS NOT THE RESPONSIBILITY OF PORTA-KING, BUT IS THE RESPONSIBILITY OF THE PURCHASER OF THE BUILDING.

APPROVED AS SUBMITTED, RELEASE FOR MANUFACTURING

APPROVED AS NOTED, RELEASE FOR MANUFACTURING

REVISE AND RESUBMIT

SIGN : \_\_\_\_\_ DATE : \_\_\_\_\_

<p align="center"><b>PORTA-KING</b> BUILDING SYSTEMS</p>		<p align="center">EARTH CITY, MISSOURI 63045</p>	
<p>4133 SHORELINE DRIVE 1-800-BUILDING 314-291-4200 FAX 314-291-2857</p>		<p>MODULAR OFFICE.COM CORDOVA, TN</p>	
<p>JOB NO. PK13882</p>		<p>DRAWN BY AYW</p>	
<p>SCALE NTS</p>		<p>DATE 2-16-09</p>	
		<p>SHEET 1 OF 3</p>	

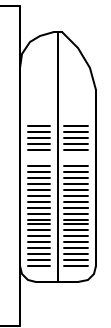

ELEVATION A



ELEVATION B

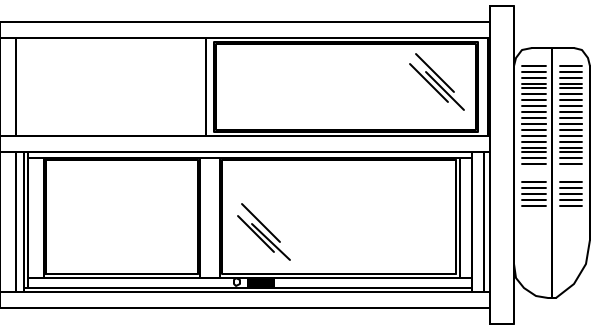
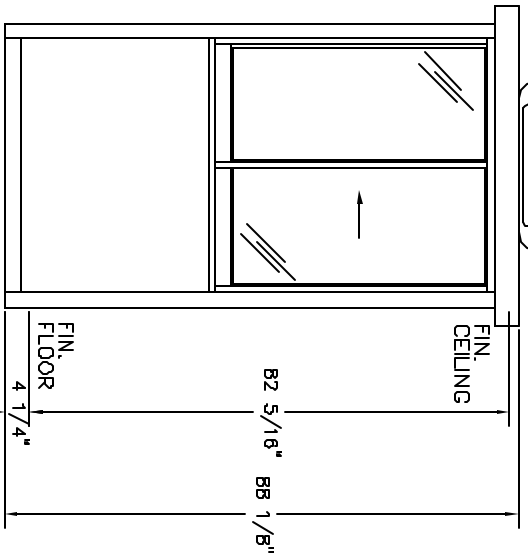

ELEVATION C

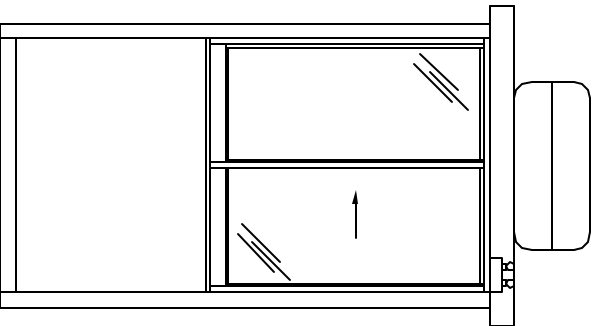

ELEVATION D

THESE DRAWINGS AND SPECIFICATIONS HAVE BEEN PREPARED IN ACCORDANCE WITH PORTA-KING'S PROPOSAL AND THE PROJECT DESIGN. THE PROJECT WILL BE MANUFACTURED IN ACCORDANCE TO THE INFORMATION AS SUBMITTED. THE SECURING OF BUILDING PERMITS AND COMPLIANCE WITH APPROPRIATE BUILDING CODES IS NOT THE RESPONSIBILITY OF PORTA-KING, BUT IS THE RESPONSIBILITY OF THE PURCHASER OF THE BUILDING.

APPROVED AS SUBMITTED, RELEASE FOR MANUFACTURING

APPROVED AS NOTED, RELEASE FOR MANUFACTURING

REVISE AND RESUBMIT

SGN : \_\_\_\_\_ DATE : \_\_\_\_\_

<p align="center"><b>PORTA-KING</b> BUILDING SYSTEMS</p> <p>4133 SHORELINE DRIVE      EARTH CITY, MISSOURI 63045          1-800-BUILDING 314-291-4200      FAX 314-291-2857</p>	
<p>TITLE MODULAR OFFICE.COM CORVOVA, TN</p>	<p>CITY OF ERIE MODEL 484BSL</p>
<p>JOB NO. PK13882</p>	<p>DRAWN BY AYW</p>
<p>SCALE NTS</p>	<p>DATE 2-16-09 REVISED -</p>
<p align="right">SHEET 2 OF 3</p>	

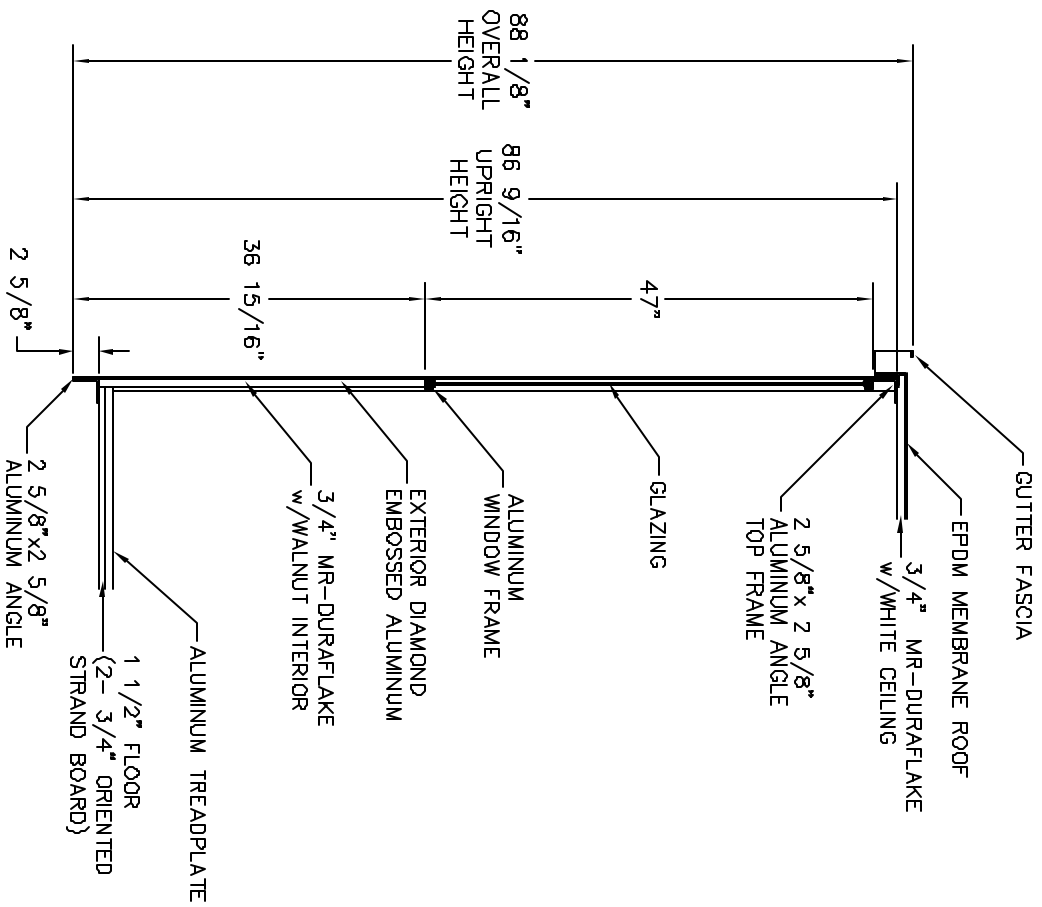

THESE DRAWINGS AND SPECIFICATIONS HAVE BEEN PREPARED IN ACCORDANCE WITH PORTA-KING'S PROPOSAL AND THE PROJECT DESIGN. THE PROJECT WILL BE MANUFACTURED IN ACCORDANCE TO THE INFORMATION AS SUBMITTED. THE SECURING OF BUILDING PERMITS AND COMPLIANCE WITH APPROPRIATE BUILDING CODES IS NOT THE RESPONSIBILITY OF PORTA-KING, BUT IS THE RESPONSIBILITY OF THE PURCHASER OF THE BUILDING.

APPROVED AS SUBMITTED, RELEASE FOR MANUFACTURING

APPROVED AS NOTED, RELEASE FOR MANUFACTURING

REVISION AND RESUBMIT

SIGN : \_\_\_\_\_ DATE : \_\_\_\_\_

WALL SECTION DETAIL

<p><b>PORTA-KING</b> BUILDING SYSTEMS</p> <p>4133 SHORELINE DRIVE EARTH CITY, MISSOURI 63045          1-800-BUILDING 314-291-4200 FAX 314-291-2857</p>		<p>CITY OF ERIE          MODEL 484BSL</p>	
<p>TITLE          MODULAR OFFICE.COM          CORDOVA, TN</p>		<p>DRAWN BY          AYW</p>	
<p>JOB NO.          PK13882</p>		<p>DATE          2-16-09</p>	
<p>SCALE          NTS</p>		<p>SHEET          3 OF 3</p>	